

The Making Of Boulder Valley Glamping

The Planning Of An Ecotourism Project

By Ar Lee Woon Poo, Nina

25th May 2019

Glamping - Glamorous Camping

A new word for a new kind of travel, a stylish get away. It emerged international and came across the Atlantic over the last decade. It gives a high level of service that focuses on the complete comfort of guests.

Both independent properties and global hospitality brands have capitalized on a jettisoning demand for travellers who want to experience the great outdoors and a little adventure in their holiday without sacrificing modern comforts and safety.



Aman Resorts - Aman-i-Khas, India



Aman Resorts – Amanwawa, Bali



Four Season Tented-Camp Golden Triangle



Banyan Tree Ras Al Khaimah Beach

Rediscover relaxation

Adventure, Wilderness, Nature

The tourism industry is in a process of metamorphosis - a new form of experiential travel focused on authentic cultural experiences, outdoor sports activities, local gastronomy and sustainable comfort.



Khanchanaburi, River Kwai Thailand



Boreal Forest At Ontario's Wilderness Region, Canada



Longitude 131 - Wilderness of Uluru-Kata Tjuta National Park



Clayoquot - Eco-safari Rainforest British Columbia, Canada



La Piantata At Italy Countryside

The Location



Boulders Valley Glamping Sites

Coordinates :
5.414993,
100.213927



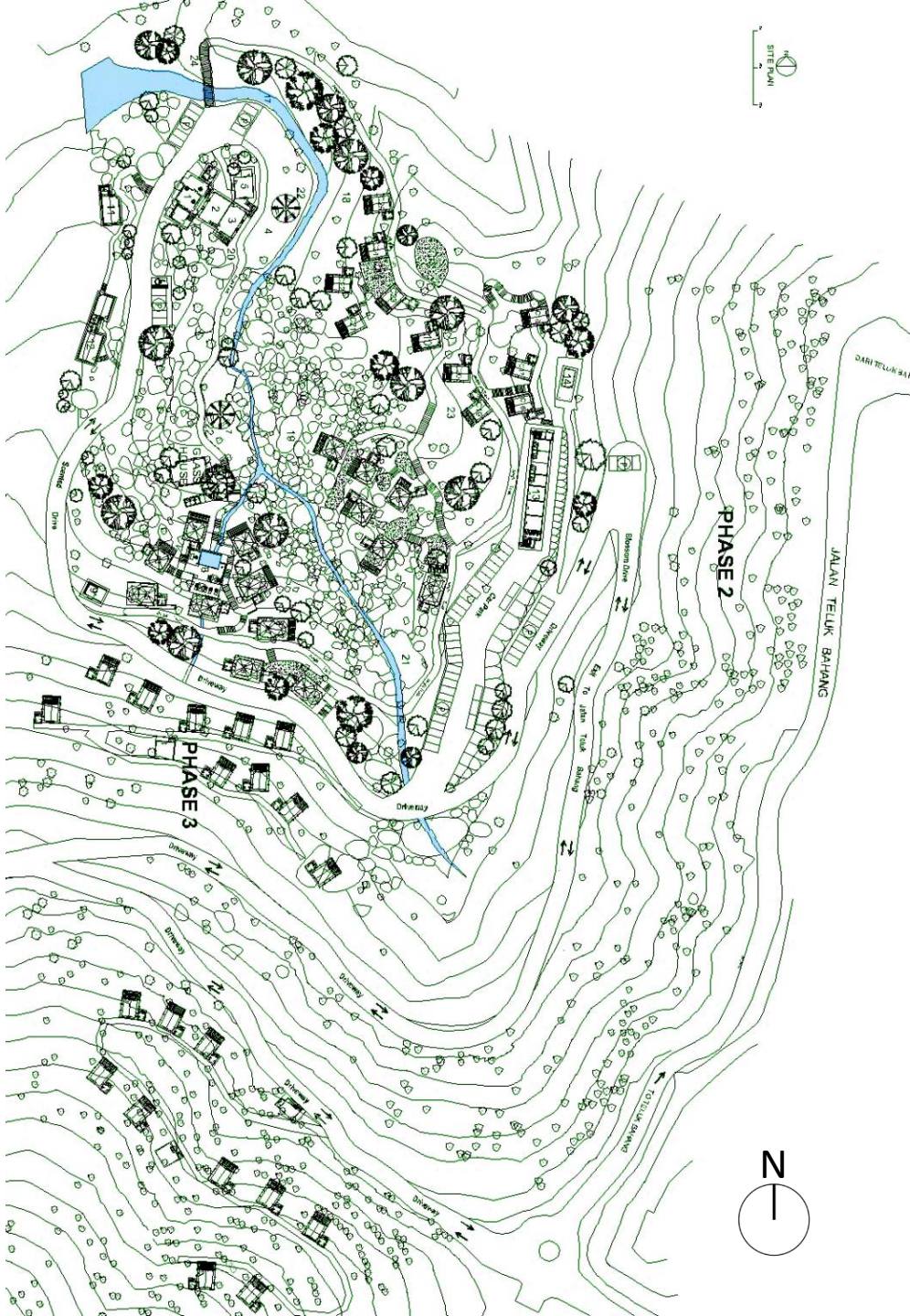

Forest Immersion with Modern Comfort

Objective of this project is

- 1) To assist human being to get back to mother nature.
- 2) To build to its minimal and to give priority to the existing environment, i.e. minimal disturbance to the slopes, boulders, streams and trees, as these are the main assets of the site.
- 3) To celebrate the nature and to maintain the biological character of the place.
- 4) To develop an idea into a bespoke operational glamorous camping site.

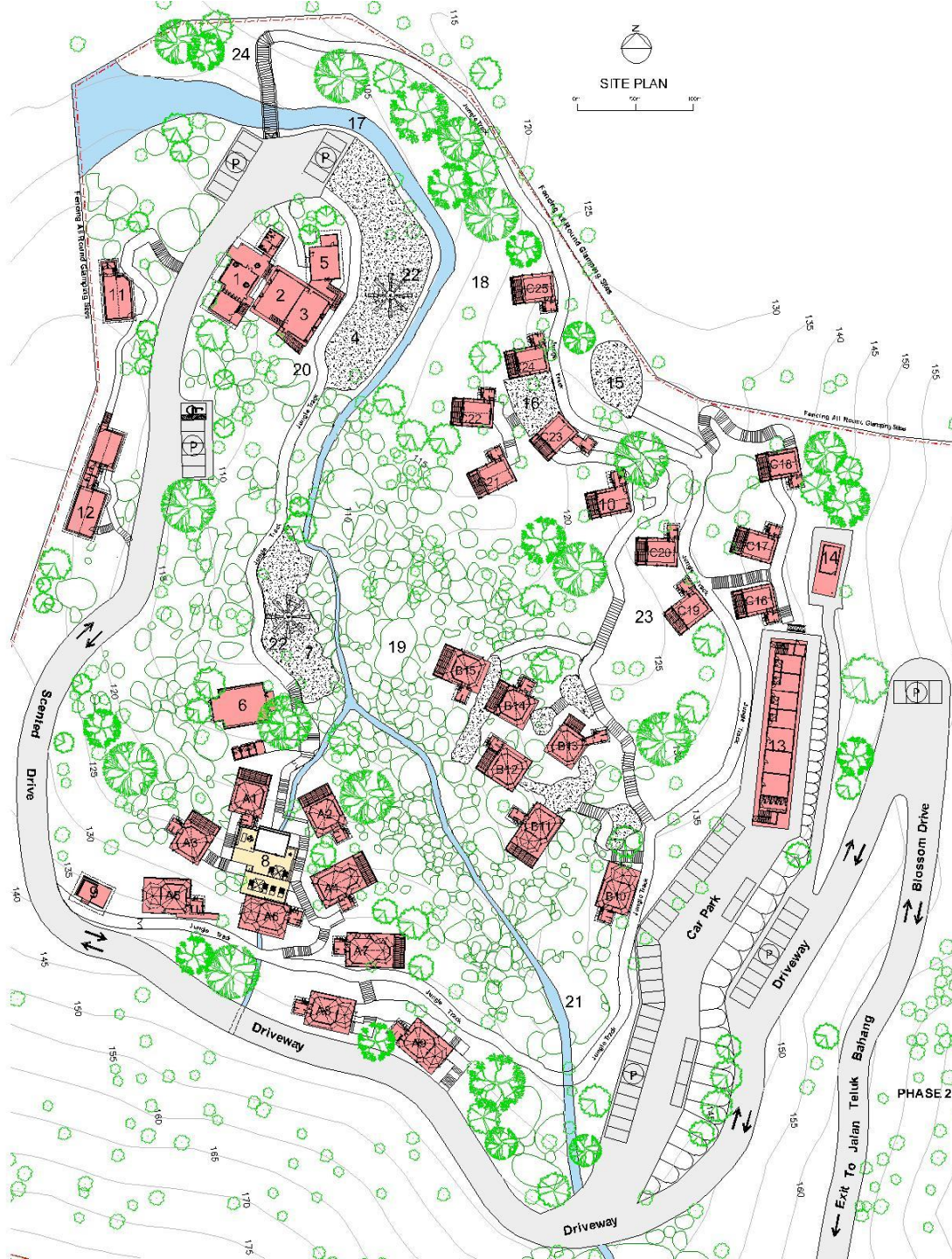

The overall building footprint is only 4.5% of the entire site which is approx 10 hectares.
The rest of the land is kept untouched.

Phase 1 – Built Up 3,200 sqm

15 Tented Villas and 10 Safari Tents and other supporting facilities

Phase 2 & 3 – Built Up 1,300 sqm

20 units of Safari Tents.



For slope surface which is hard and steep and difficult for the grass seeds to growth, a layer of fibromat is added on after the seeds are sprayed on the slope.

The site

- 1) is situated at a highly environmental sensitive area
- 2) remote from civilisation
- 3) with complex planning regulations. It is subject to stringent environmental requirements and hill land development regulations.

** Good environmental management practise has been implemented during the construction.

To ensure good hill land development practise is being carried out, we insisted on minimal hill cutting.

Hill cutting and touch up is carried out as sufficient to create driveway and jungle tracks only.

These driveways with gentle gradients are delicately designed to follow the existing contour.

Hydroseeding

0 week



Made of natural agricultural straw and fibers, and stitched together with degradable thread to a double layer photodegradable polypropylene netting. The Fibromat Biodegradable Erosion Control Blanket (ECB) immediately reduces soil erosion losses by 85% after installation.

A close-up photograph of a hydroseeded area. The ground is covered with a thick layer of dry, golden-brown straw or hay. A white, fibrous erosion control netting is visible, partially covered by the straw. Several young, green grass seedlings are growing through the straw and netting. The background is a blurred view of green trees and a clear blue sky.

Hydroseeding

After 3-4 Weeks

Subsequently, effective grass establishment is achieved by hydroseeding. It is the best Erosion Protection System that uses together with hydroseeding. The stage of growth around 20%, the growth can be seen in 2-4 weeks after mixture is sprayed to the slope. It depends on the weather and soil condition.

Hydroseeding

After 3-4 Weeks



3-4 weeks

Hydroseeding

After 3-4 Months



After The final stage of growth, the growth can be seen after 3 to 4 months.

Hydroseeding

After 3-4 Weeks



The stage of growth around 20%, the growth can be seen in 3-4 weeks after mixture is sprayed to the slope. It depends on the weather and soil condition.

Hydroseeding

After 9-12 months



After

Hydroseeding

After 9-12 Months

Bermuda Grass

Types Grass Seed of Hydroseeding

- Signal Grass (Brachiaria Decumbers)
- Bermuda Grass (Cynodon Dactylon)
- Ruzi Grass

The Plants Evolves
After 2 Years

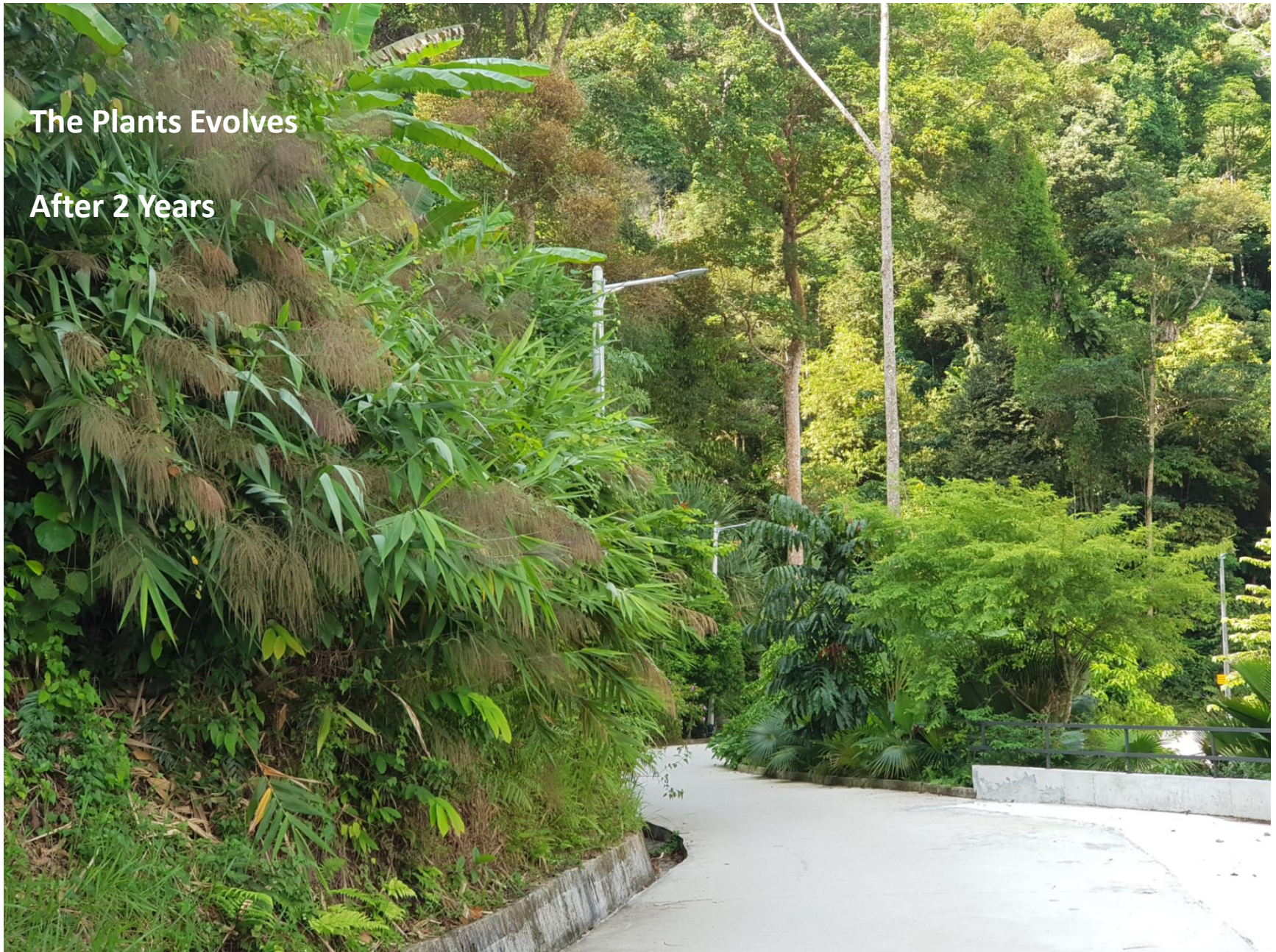

The plants evolves by itself. The fittest survives...

The Plants Evolves

After 5 years

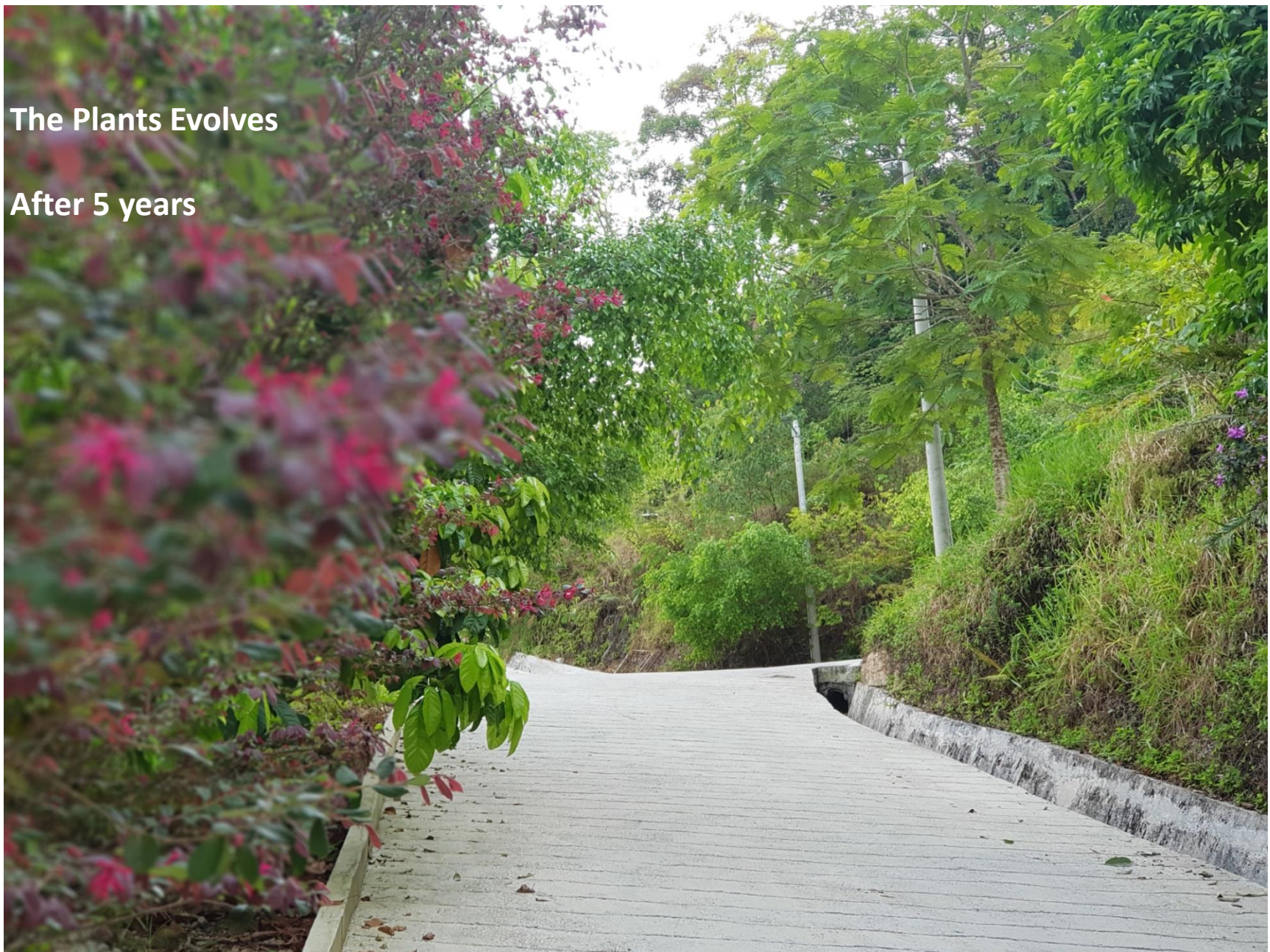

The plants evolves by itself. The fittest survives...

The Plants Evolves

After 5 Years



The hardwood plants have grown and flowered. The Bermuda Grass is gone and the landscape changes by itself. The plants evolves by itself. The fittest survives...

** Lesson learnt - Let the nature decide on the landscape design.

Good Drainage System



- A good **Environmental Management Plan** during the implementation is important.
- Good drainage system, sufficient berm drains is crucial.
- We also revitalised many dried off water ways by leading water back to their original water ways.



Numbering Trees

There are many technical difficulties in developing a project in remote location and the bioclimatic requirements of building in the tropics. Respecting the natural bioclimatic ecosystem and pragmatic approach has to be applied during the implementation with high ethics and moral.



Manual setting up Avoiding boulders and trees

It was very difficult to do planning works on drawing board due to its large land size and limited information that can be retrieved from the surveyor plan.

To resolve this, we numbered matured trees and giant boulders to enable the team to identify their physical location during planning and construction stage.

Planning on drawing is only as indication, actual setting out of platform and most of the construction works has to be determined on site.

***Lesson learnt - The site itself will tell us how to decide on the overall planning.

Formation of Jungle Glades

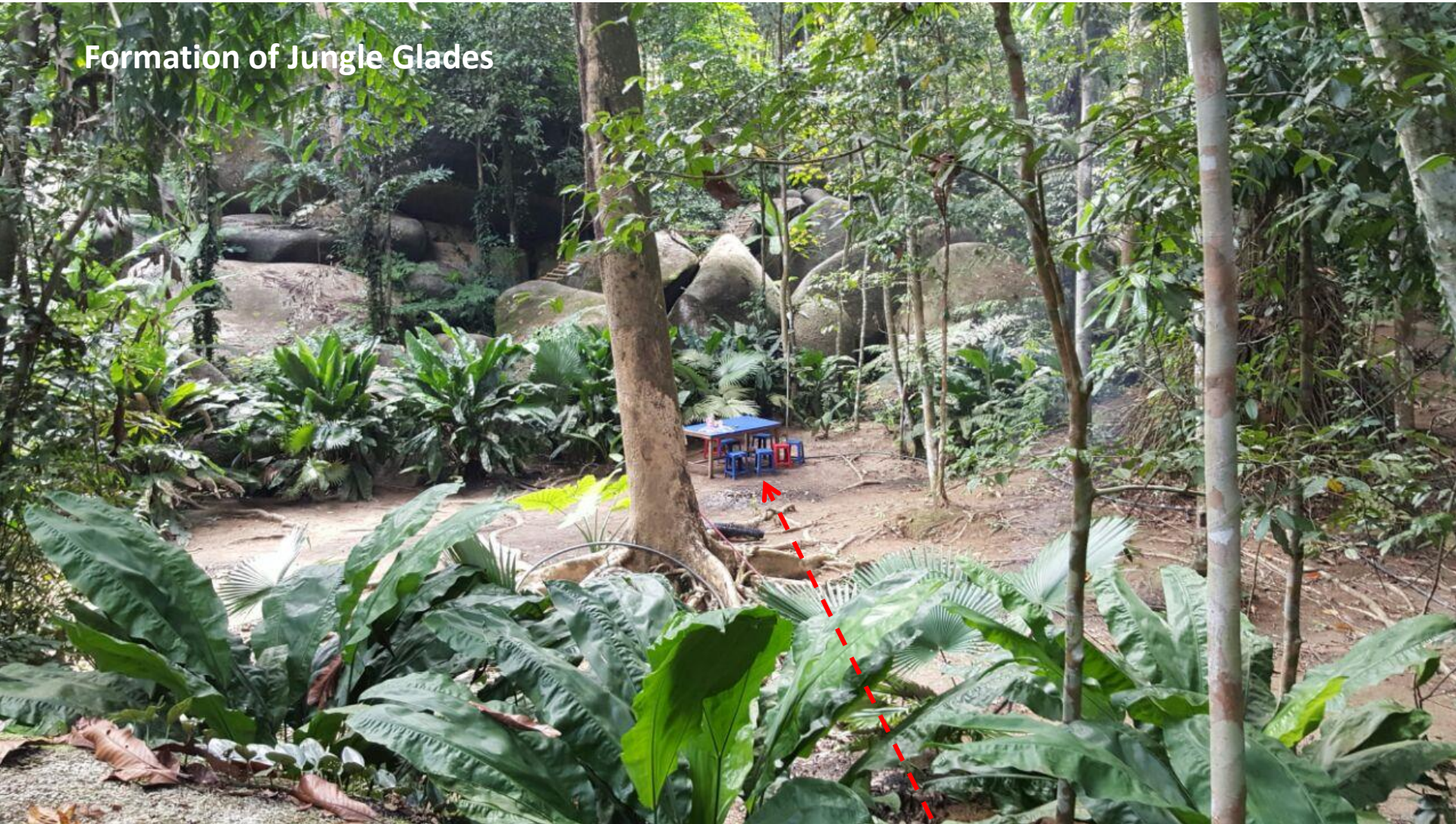

Before

Site Office

Formation of Jungle Glades



After

** Maintaining the Existing State of the Site – trees, plants and boulders are well kept. Giant fan is introduced to enhance the comfort of guests.

** The works involved were merely tidying up the site.

Formation of Jungle Glades

Initially by manpower, the task was tough

Later the works was assisted by mini machinery



- Due to inexistence of any access, the construction becoming even more difficult especially delivery of material.
- Mini machineries and extensive manpower been used.
- This has prolonged the construction period and escalated the construction cost.



Formation of Tracks



Clearing Undergrowth & Forming Tracks

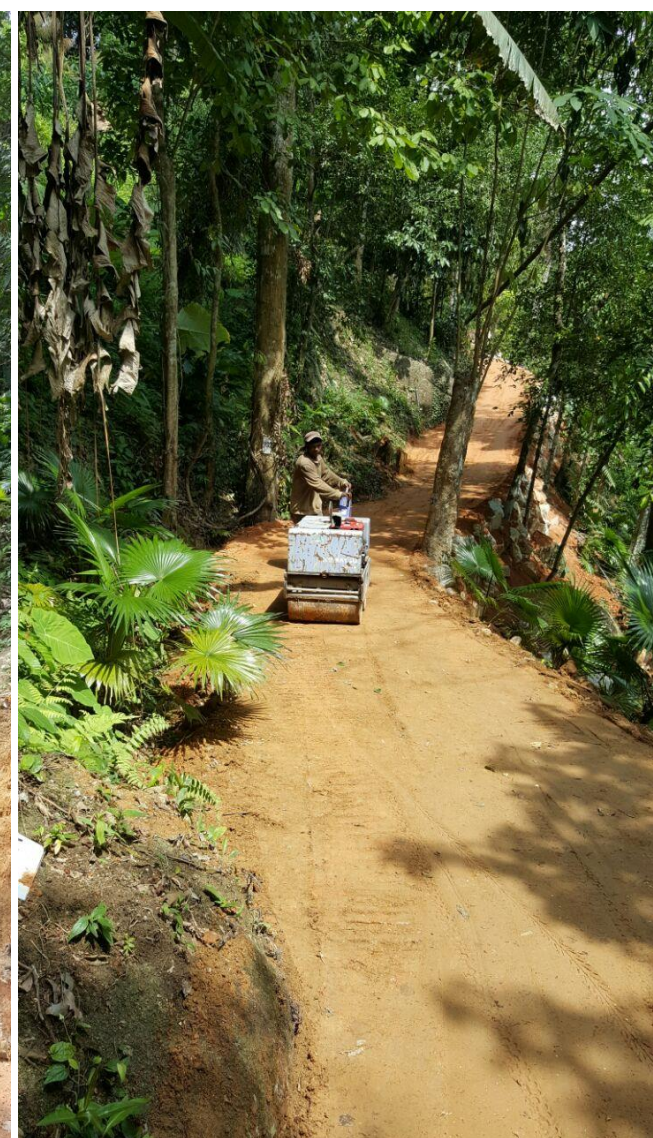

Lay Crusher run, Hand Rolling Compaction before concreting

Before

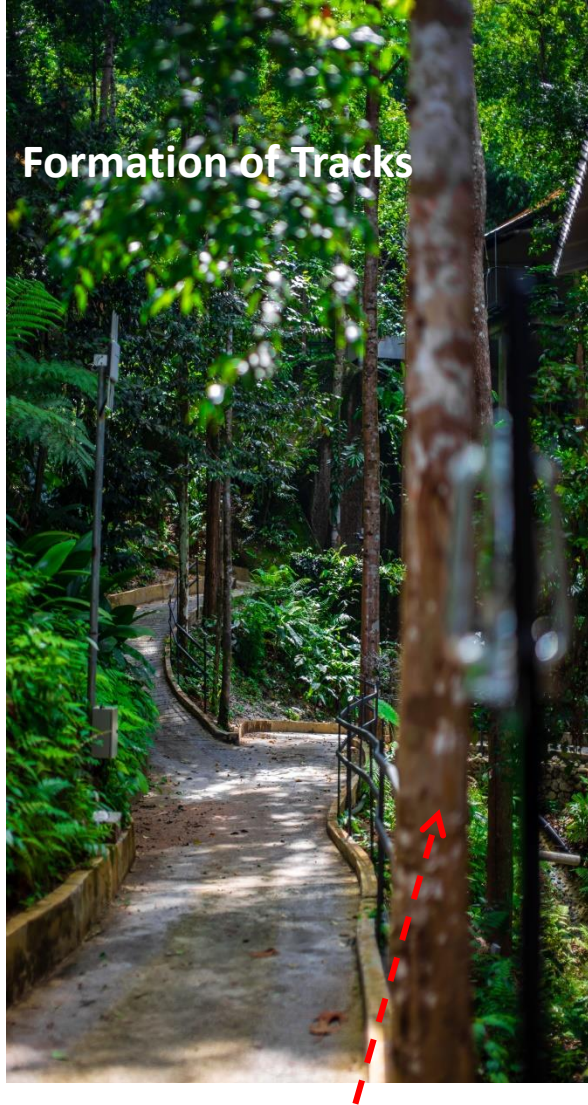

Formation of Tracks

Existing Trees



Existing Boulders

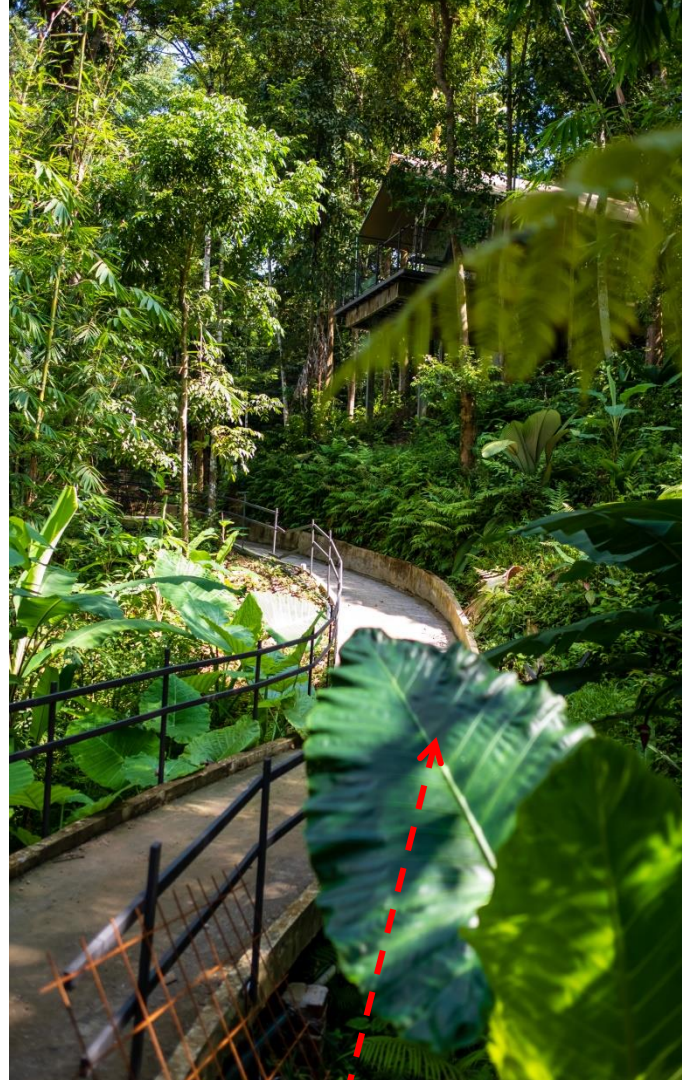

Existing Plants

After

- Gentle Jungle and Buggy Tracks
- Existing trees, plants and boulders are maintained
- Comfortable, safe, easy to walk
- Light up with Traditional Kerosene Lamp



'Intention'

Laku

'Act'

Hasil

'Consequence'

- 1) To assist human being to get back to mother nature.
- 2) To build to its minimal and to give priority to the existing environment
- 3) To celebrate the nature
- 4) To develop a bespoke operational glamorous camping site.

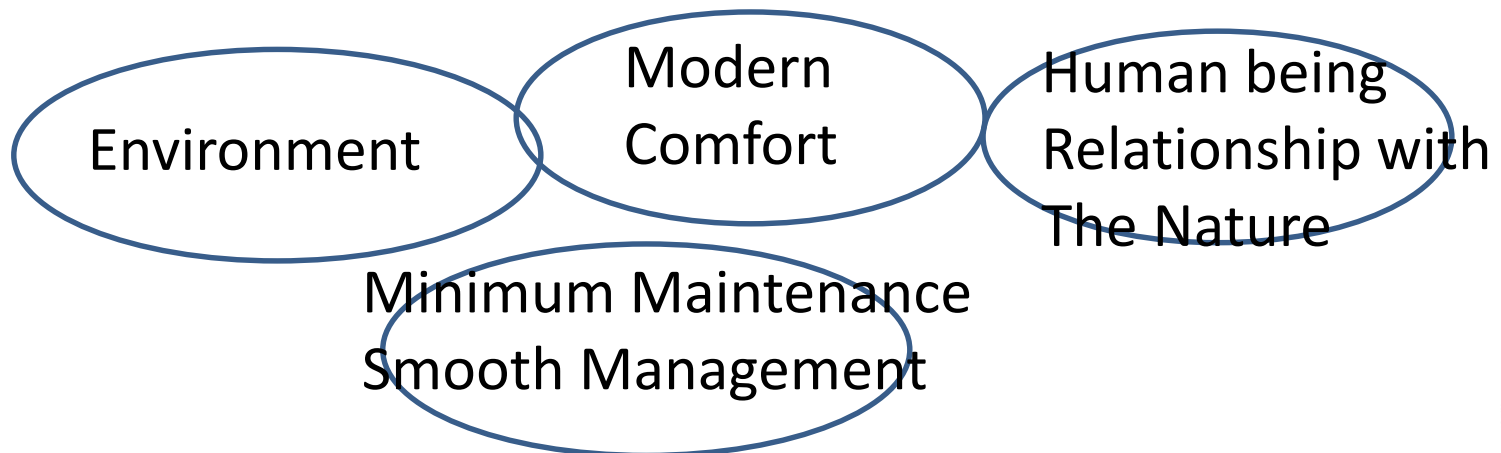

Tree Top Experiences



Tree Pod



Bird Nest



Tree House

Boulder Valley Way of Tree Top Experiences



Tree Tent



Tree Top Safari Tent

Tree Top Experiences

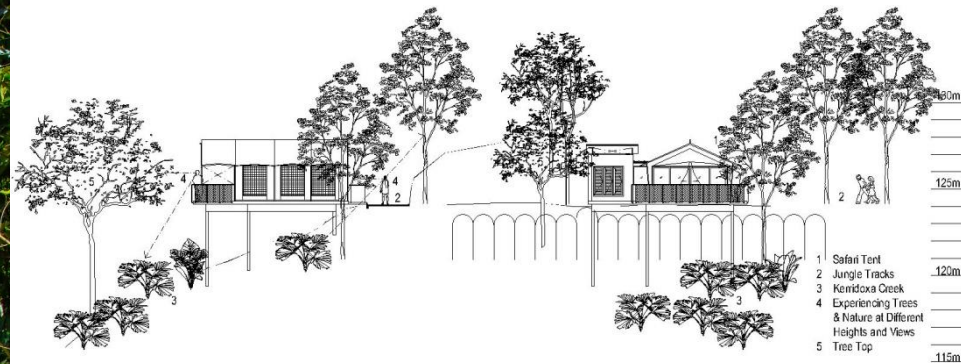

5 Buildings platforms are on stilts. Tents and other building platforms perched delicately on stilts thus avoid the fragile root of the existing trees and allow the water to run through its original path. They can be removed from the site without affecting the jungle's original state.

6 Each tree top tented villas and safari tents have a private deck that extends into the jungle. Some of the decks are made transparent with netting material on its own way to enable guest to appreciate plants in different perspectives. Thus offering an out-of-routine experience.





Giant Fans - Energy saving, low speed high volume giant fans are introduced at indoor and outdoor common area to enhance guest comfort.



Giant Plants - Jurassic Style Garden is introduced. Due to the fertility of soil and day-night differential temperature, plants grow into gigantic size with fertilise. 4m-6mH plants.



Giant Taro



Giant Boulders -This project is named after its physical site where boulder valley is for all the large boulders that have cascaded into the valley over the eons.

Jurassic Style Garden



Use of canvas giving a sense of temporary and outdoor, while glass walls are used extensively to enable guests to immerse into the nature even they are indoor.



Traditional kerosene lanterns enhance the spirit of camping while lighting up the night.



Jungle Glades has become the focal point for outdoor activities, camp-adventure, pre-function area, team building, yoga and etc.



To minimise hill disturbance to the existing slopes, building platforms are built according to its terrain, hence creating a double volume restaurant space.

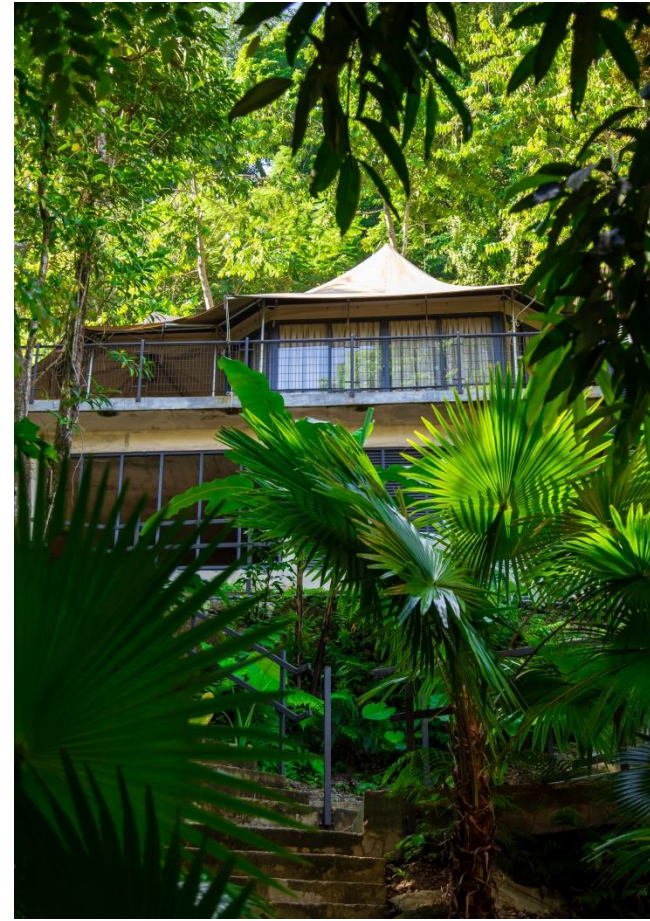

The architectural detailing are intentionally kept basic and free from over lavishness, it turned out to have its own beauty on its own way.



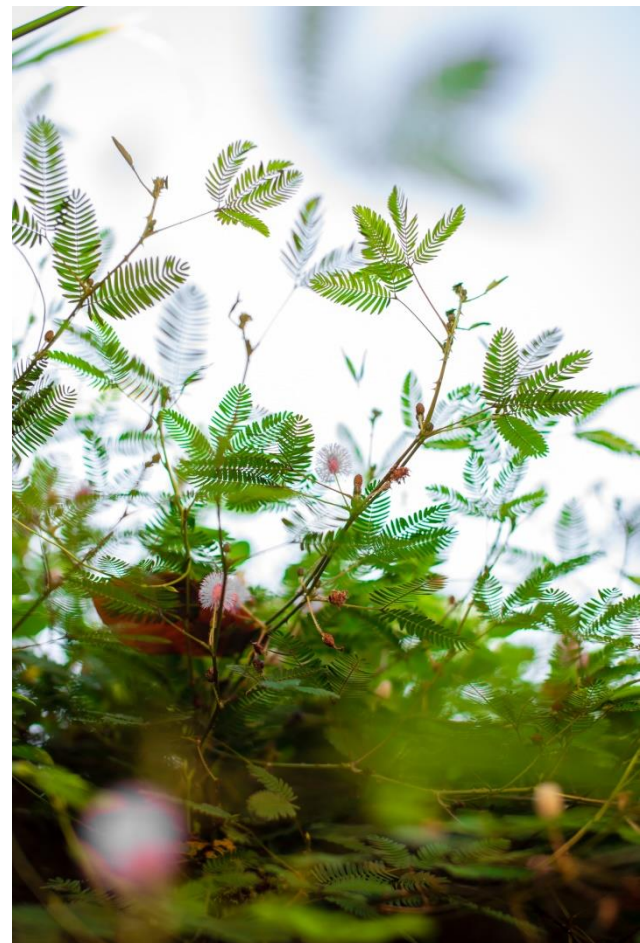



Boulder Valley Glamping

This project is named after its physical site – Boulder Valley.

The logo consists of

- A Boulder
- Valley
- Roof of a tent





We designed this chair after an
adirondack outdoor chair,
- modified, simplified.

Descriptions about this chair ~

Nature
outdoor
patio
lawn
chair
wet
summer
camping
fresh rain
relax
leisure
life style
patio
new look
cute
rest
new camping style....





We worked with the kitchen to design Glamping Recipes, Outdoor Dining, Picnic Style to give a complete glamping experience.

Descriptions about this recipes~

Camp Bread

Dip S'more

Minestrone Stew

Dutch Oven

Roasted Whole Chicken

Mac 'n' Cheese

Egg Bacon Muffin

Barbeque

Outdoor

Camp Fire

Picnic

Nature

New Camping Style

Life Style

Summer

Leisure

Fun



The Way Forward

- Eco-farming will be introduced
- A concept of which ensures healthy food by protecting soil, water and climate, promotes biodiversity, labour, knowledge and technology and does not contaminate the environment with chemical inputs or genetic engineering. No any fertiliser even organic fertiliser will be used.
- Mushrooms, Edible plants, Medicinal Herbs, Spices, Nutmeg, Cloves will be planted, Harvesting Stingless Bees
- Boulder Valley Glamping will be made as the epicenter of another 2 ecoparks at Sungai Yu , Gua Musang.
- It will be turned into a De-stress, health, detox and recuperation centre.

Celebration Of Nature

After the site is ready, many programmes brought in by different groups in reaction to nature had made the soul for the glamping site.

~ Thank You ~

Conceptualisation - Design Innovation - Critical Analysis
Design Sensitivity – Sustainability – Place Making – Forward Thinking

